

DR. LALMOHAN BHATTACHARJEE ROAD

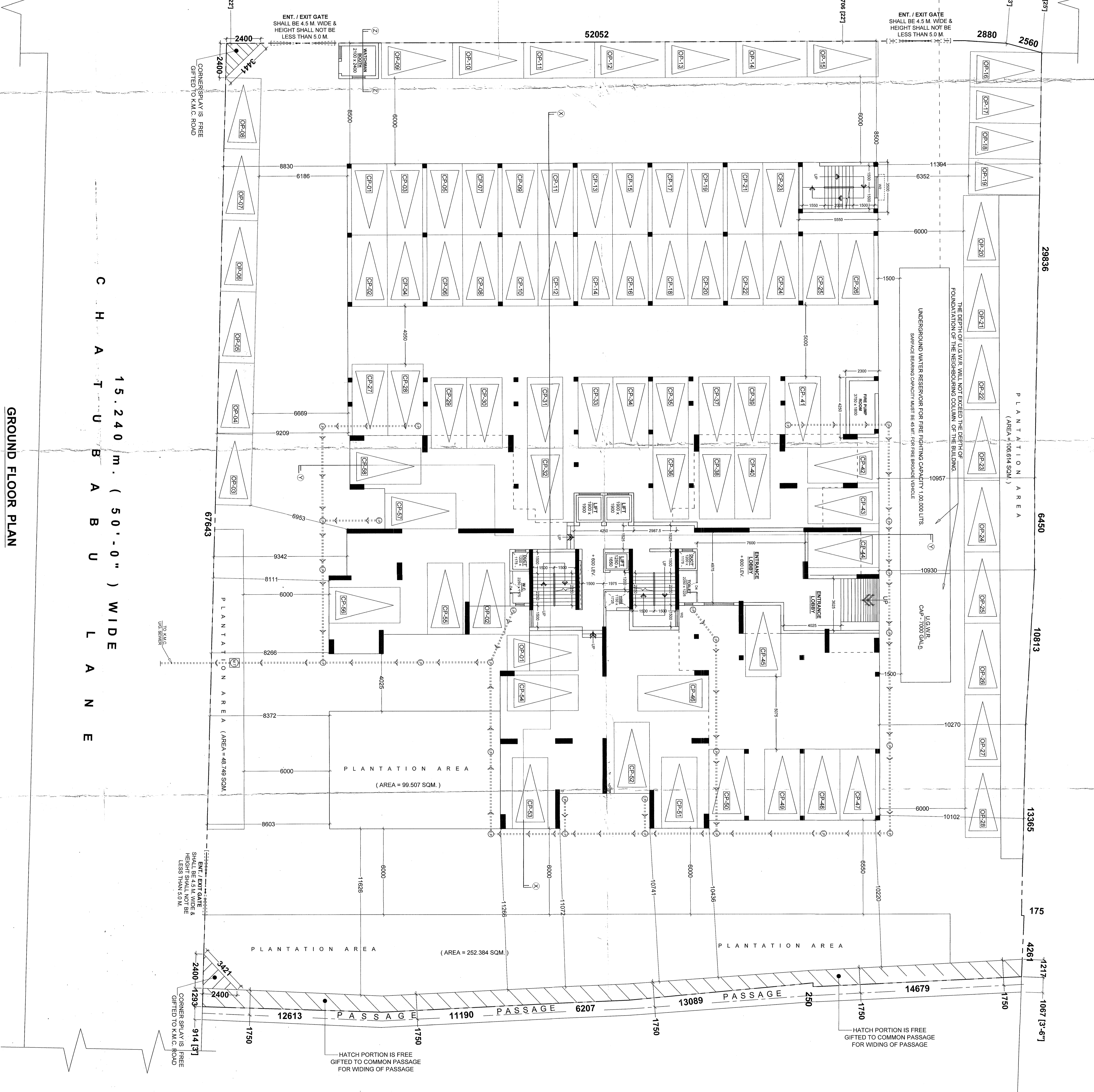

15.240 m. (50'-0") WIDE
C H A T T U B A B U L A N E

GROUND FLOOR PLAN

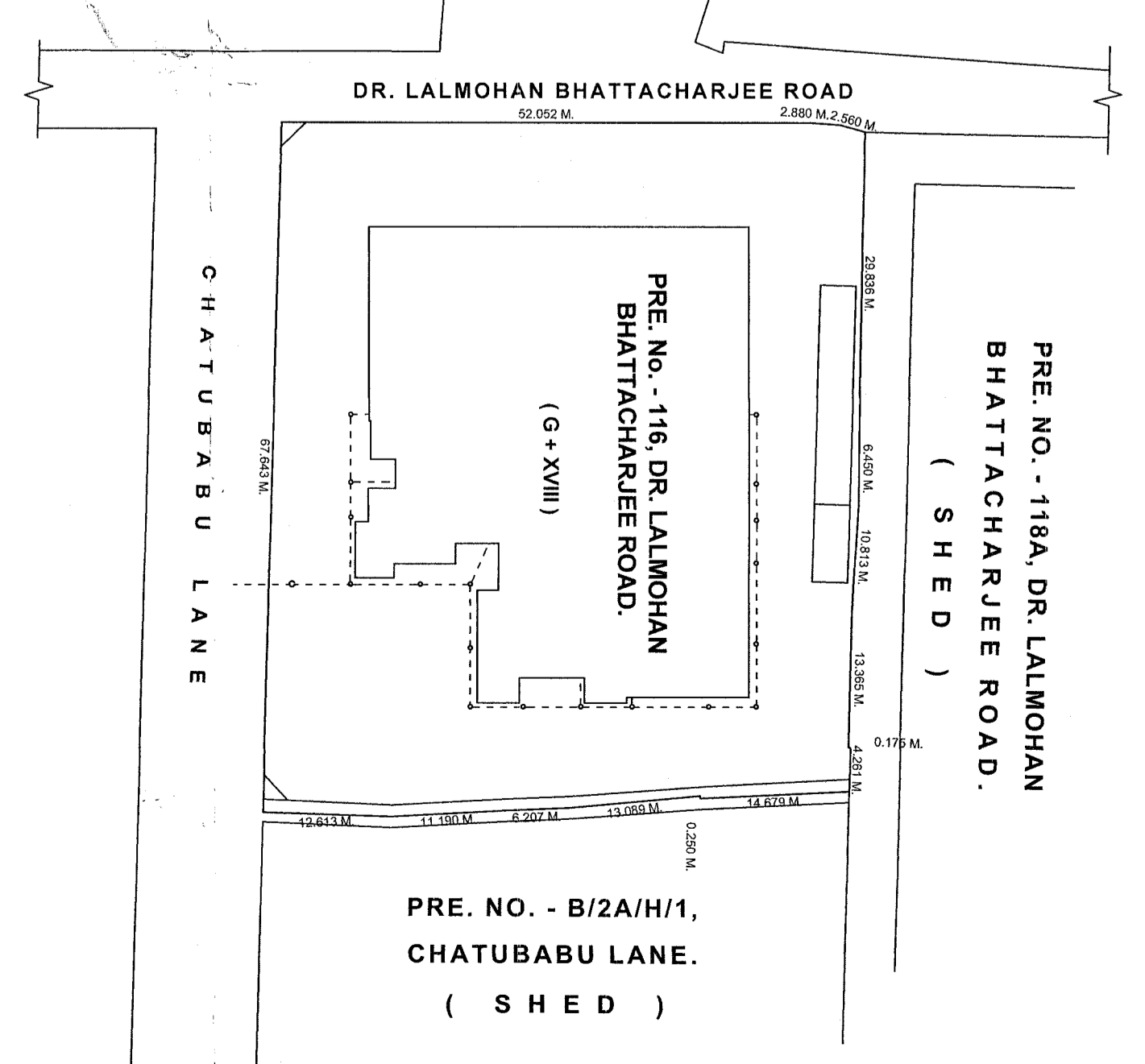
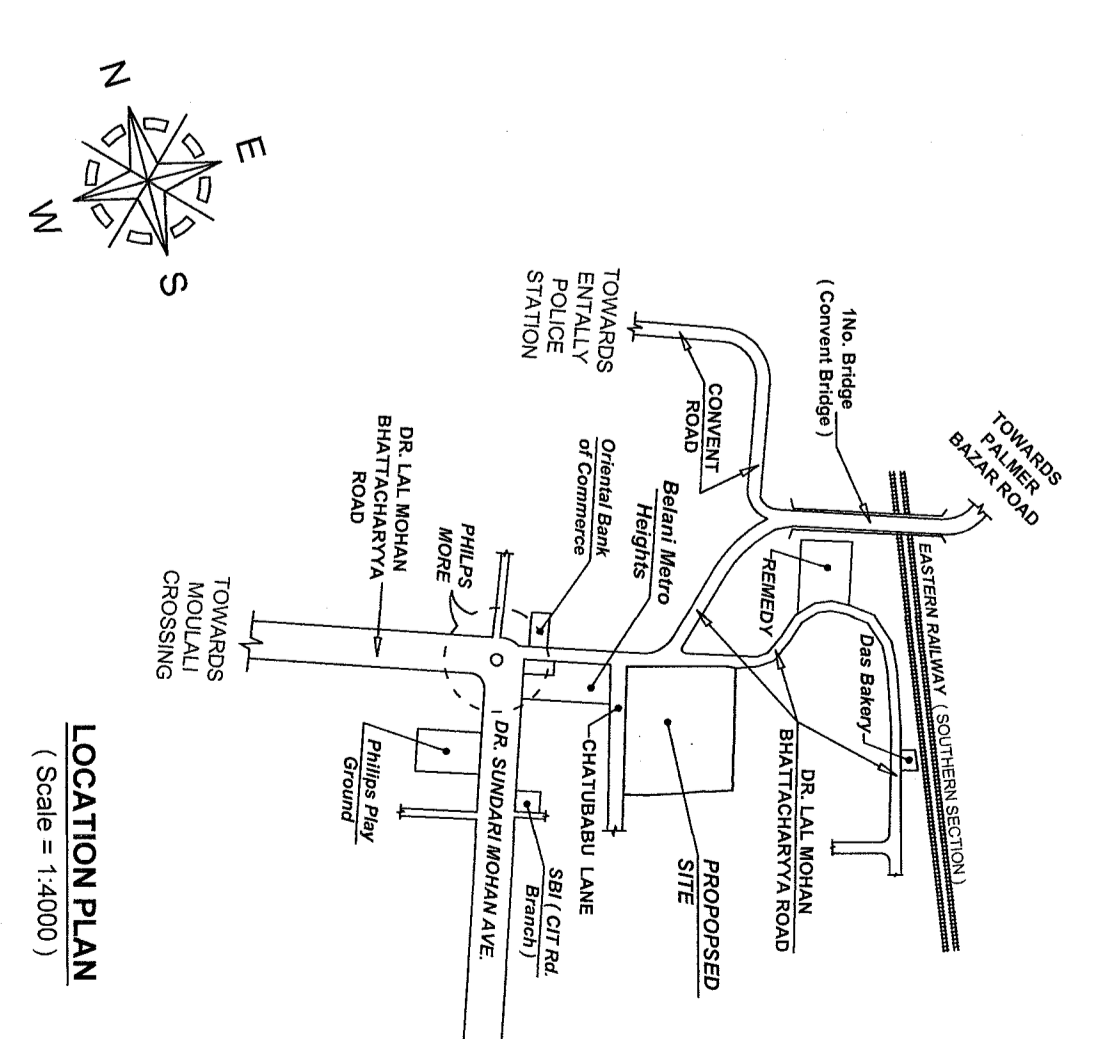

SITE PLAN (SCALE = 1:1000)

I DO HEREBY DECLARE WITH FULL RESPONSIBILITY THAT I SHALL FOLLOW THE INSTRUCTIONS OF L.S. & E.S.E. DURING CONSTRUCTION OF THE BUILDING AS PER THE PLAN. K.M.C. AUTHORITY WILL NOT BE RESPONSIBLE FOR STRUCTURAL STABILITY OF THE BUILDING. THE K.M.C. AUTHORITY WILL REMOVE THE SANCTION PLAN, THE CONSTRUCTION OF WATER RESERVOIR AND SEPTIC TANK WILL BE UNDERTAKEN UNDER THE GUIDANCE OF E.S.E./L.S. BEFORE STARTING OF BUILDING FOUNDATION WORK.

For K. K. REALTYSTATES
 For K. K. REALTYSTATES
 For K. K. REALTYSTATES
 For K. K. REALTYSTATES

THE STRUCTURAL DESIGN AND DRAWINGS OF BOTH FOUNDATION AND SUPERSTRUCTURE OF THE BUILDING HAS BEEN MADE BY ME CONSIDERING ALL INDIA AND CERTIFIED THAT IT IS SAFE AND STABLE IN ALL RESPECT.

PROPOSED NINETEEN (19) STOREY (Height of the Building is 60.000 M) BUILDING IN PRE NO. 118 DR. LALMOHAN BHATTACHARJEE ROAD, P. S. ENVALKA, WARD NO. 55, BROUOH - VI.

SCALE: W-46
 1:50
 1:100
 1:400

SHEET 1

SM SRI MURUGAN ENGINEERING AND ARCHITECTURE

PARTY'S COPY

Before starting any construction the work must conform with the plans submitted and approved in the plan. The validity of the written permission is subject to the above conditions.

Plan for Water Supply arrangement including S.E.M.I.L. G. & O. H. of the Engineer Water Supply and the sanction obtained before proceeding with the construction. The sanction may be subject to reconstruction.

Water supply should be fixed in discharge on Road or Footpath. The sanction should be obtained from the Engineer's Office and the sanction obtained before proceeding with the drainage work.

A suitable pump has to be provided in pumping units and urinals in the building. In case of urinals in the building, unfiltered water from street main is not available.

RESIDUAL WELDMENT DETENTION

Approved By: *[Signature]*
The Building Controller

An Building Materials to necessary & construction should conform to the National Building Code of India.

THE SANCTION IS VALUED UP TO RS. 1,00,000/-

APPROVED
[Signature]
ASSISTANT ENGINEER (D)
BRIHADDHAR
NO.

Work is subject to Compliance of National Building Code of India, wherever applicable.

* Provision for use of solar energy in the form of solar heater and/or solar photovoltaic shall be provided as required under Rule 147 of Building Code, 2008 and completion certificate will not be issued in case of building not having solar provision.

Shaded portion - Backfilling, excavation, etc. shall be done as per the K.M.C. and no wall can be constructed over it.

The building materials that will be stacked on Road/Passage or Footpath shall be covered with a tarpaulin sheet or G.P. Floor, whichever is available, and the same shall be removed immediately after the work is completed.

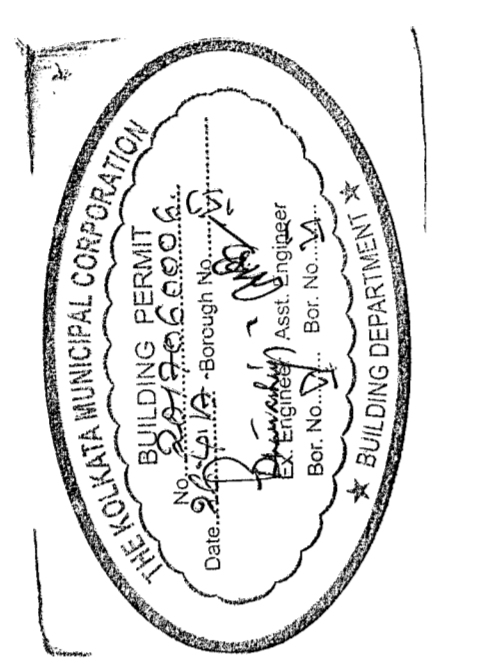

CONSTRUCTION SITE SHALL BE MAINTAINED TO PREVENT MOSQUITO BREEDING AS REQUIRED UNDER RULE 147 OF BUILDING CODE, 2008. SO THAT ALL WATERS COLLECTION PARTICULARLY LIFT WELLS, VANS, BARBENT DURING OPEN CONSTRUCTION, ETC. MUST BE EMPTIED COMPLETELY TWICE A WEEK.

RESIDENTIAL BUILDING